

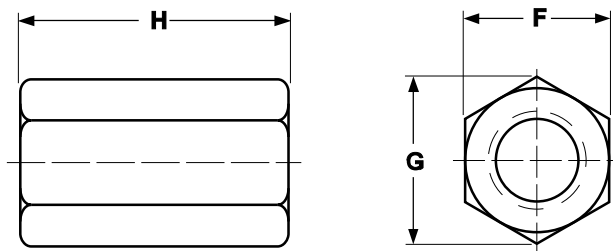

TRANSHOW INDUSTRY LIMITED

GAOYANG RD, ZHOUHAN VILLAGE, JIANGSHAN TOWN
 YINZHOU DISTRICT, NINGBO CITY, 315100 CHINA
 Tel: +86-574-8736.7873 Fax: +86-574-8736.4349
 www.transhow.net Email: transhow@transhow.net

IFI 128-2000 Hex Coupling Nuts



HEX COUPLING NUTS									
Nominal Size and Threads per Inch	Basic Major Diameter of Thread	F			G		H		
		Idth Across Flats			Width Across Corner		Length		
		Basic	Max	Min	Max	Min	Basic	Max	Min
8-32	0.1640	5/16	0.312	0.302	0.361	0.344	5/8	0.64	0.61
10-24	0.1900	5/16	0.312	0.302	0.361	0.344	3/4	0.76	0.74
10-32	0.1900	5/16	0.312	0.302	0.361	0.344	3/4	0.76	0.74
1/4-20	0.2500	3/8	0.375	0.365	0.433	0.416	7/8	0.89	0.86
1/4-20	0.2500	7/16	0.438	0.428	0.505	0.488	1-1/2	1.51	1.49
1/4-20	0.2500	7/16	0.438	0.428	0.505	0.488	1-3/4	1.76	1.73
1/4-28	0.2500	3/8	0.375	0.365	0.433	0.416	7/8	0.89	0.86
5/16-18	0.3125	1/2	0.500	0.489	0.577	0.557	7/8	0.89	0.86
5/16-18	0.3125	1/2	0.500	0.489	0.577	0.557	1-1/8	1.13	1.11
5/16-24	0.3125	7/16	0.438	0.428	0.505	0.488	7/8	0.89	0.86
3/8-16	0.3750	1/2	0.500	0.489	0.577	0.557	1-1/8	1.13	1.11
3/8-16	0.3750	5/8	0.625	0.613	0.722	0.698	1-3/4	1.76	1.73
3/8-24	0.3750	1/2	0.500	0.489	0.577	0.557	1-1/8	1.13	1.11
1/2-13	0.5000	5/8	0.625	0.613	0.722	0.698	1-1/4	1.26	1.24
1/2-13	0.5000	11/16	0.688	0.663	0.794	0.756	1-3/4	1.76	1.73
1/2-20	0.5000	5/8	0.625	0.613	0.722	0.698	1-1/4	1.26	1.24
5/8-11	0.6250	13/16	0.813	0.782	0.939	0.891	2-1/8	2.14	2.10
5/8-18	0.6250	13/16	0.813	0.782	0.939	0.891	2-1/8	2.14	2.10
3/4-10	0.7500	1	1.000	0.963	1.155	1.097	2-1/4	2.27	2.22
3/4-10	0.7500	1	1.000	0.963	1.155	1.097	2-1/4	2.27	2.22
7/8-9	0.8750	1-1/4	1.250	1.212	1.443	1.382	2-1/2	2.53	2.47
1-8	1.0000	1-3/8	1.375	1.325	1.588	1.511	2-3/4	2.78	2.72