

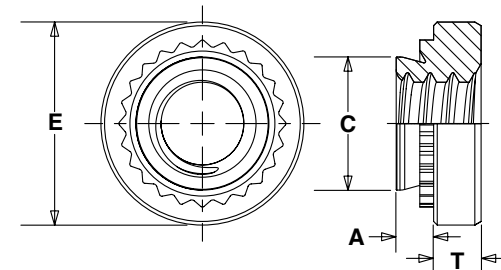

## TRANSHOW SCREW FACTORY

GAOYANG RD, ZHOuhan VILLAGE, JIANGSHAN TOWN  
 YINZHOU DISTRICT, NINGBO CITY, 315100 CHINA  
 Tel: +86-574-8736.7873 Fax: +86-574-8736.4349  
[www.transhow.net](http://www.transhow.net) Email: [transhow@transhow.net](mailto:transhow@transhow.net)



### Self Clinching Nut-Metric Specifications

	Thread Size	Type			Thread Code	Shank Code	A (Shank) Max.	Rec. Min. Sheet Thickness (1)	Hole Size In Sheet +0.08	C Max.	E ±0.25	T ±0.25	Min. Dist. Hole $\phi$ To Edge (2)
		Fastener Material											
		Carbon Steel	Stainless Steel	Hardened Stainless Steel									
METRIC	M2 x 0.4	S	CLS	—	M2	0	0.77	0.8	4.22	4.2	6.35	1.5	4.8
						1	0.97	1					
						2	1.38	1.4					
	M2.5 x 0.45	S	CLS	—	M2.5	0	0.77	0.8	4.22	4.2	6.35	1.5	4.8
						1	0.97	1					
						2	1.38	1.4					
	M3 x 0.5	S	CLS	SP	M3	0	0.77	0.8	4.22	4.2	6.35	1.5	4.8
						1	0.97	1					
						2	1.38	1.4					
	M3.5 x 0.6	S	CLS	—	M3.5	0	0.77	0.8	4.75	4.73	7.11	1.5	5.6
						1	0.97	1					
						2	1.38	1.4					
	M4 x 0.7	S	CLS	SP	M4	0	0.77	0.8	5.41	5.38	7.87	2	6.9
						1	0.97	1					
						2	1.38	1.4					
	M5 x 0.8	SS	CLSS	SP	M5	0	0.77	0.8	6.35	6.33	8.64	2	7.1
						1	0.97	1					
						2	1.38	1.4					
	M6 x 1	S <sup>(4)</sup>	CLS	SP	M6	00 <sup>(3)</sup>	0.89	0.92	8.75	8.73	11.18	4.08	8.6
						0 <sup>(3)</sup>	1.15	1.2					
1						1.38	1.4						
2						2.21	2.29						
M8 x 1.25	S <sup>(4)</sup>	CLS	SP	M8	1	1.38	1.4	10.5	10.47	12.7	5.47	9.7	
					2	2.21	2.29						
M10 x 1.5	S	CLS	SP	M10	1	2.21	2.29	14	13.97	17.35	7.48	13.5	
					2 <sup>(3)</sup>	3.05	3.18						
M12 x 1.75	S	—	—	M12	1	3.05	3.18	17	16.95	20.57	8.5	16	